

TURN-KEY OFFICE SPACE FOR LEASE



2601 Skyway Dr, Suite A3, Santa Maria, CA



Office 805.481.9010
170 West Grand Ave, Suite 203
Grover Beach, CA 93433

Taylor Castanon

Associate DRE 02113056

Mobile 805.440.7748

Email taylor@hartcre.com

OVERVIEW

2601 Skyway Dr, Suite A3, Santa Maria, CA

Located at the signalized intersection of Skyway and Fairway, The Fair Sky Park is close to the Santa Maria Airport with easy access to Broadway (HWY 135). This well maintained building offers great visibility and plenty of parking. This suite offers 6 private offices, large bullpen area, huge conference room and private restrooms.

Suite	Gross SF	Rate
A3	± 3,143 SF	\$1.45/SF, Gross

- > Improved office space near the Santa Maria Airport
- > Excellent visibility at corner of Fairway & Skyway Dr
- > Ample Parking
- > Zoning M1



FLOORPLAN

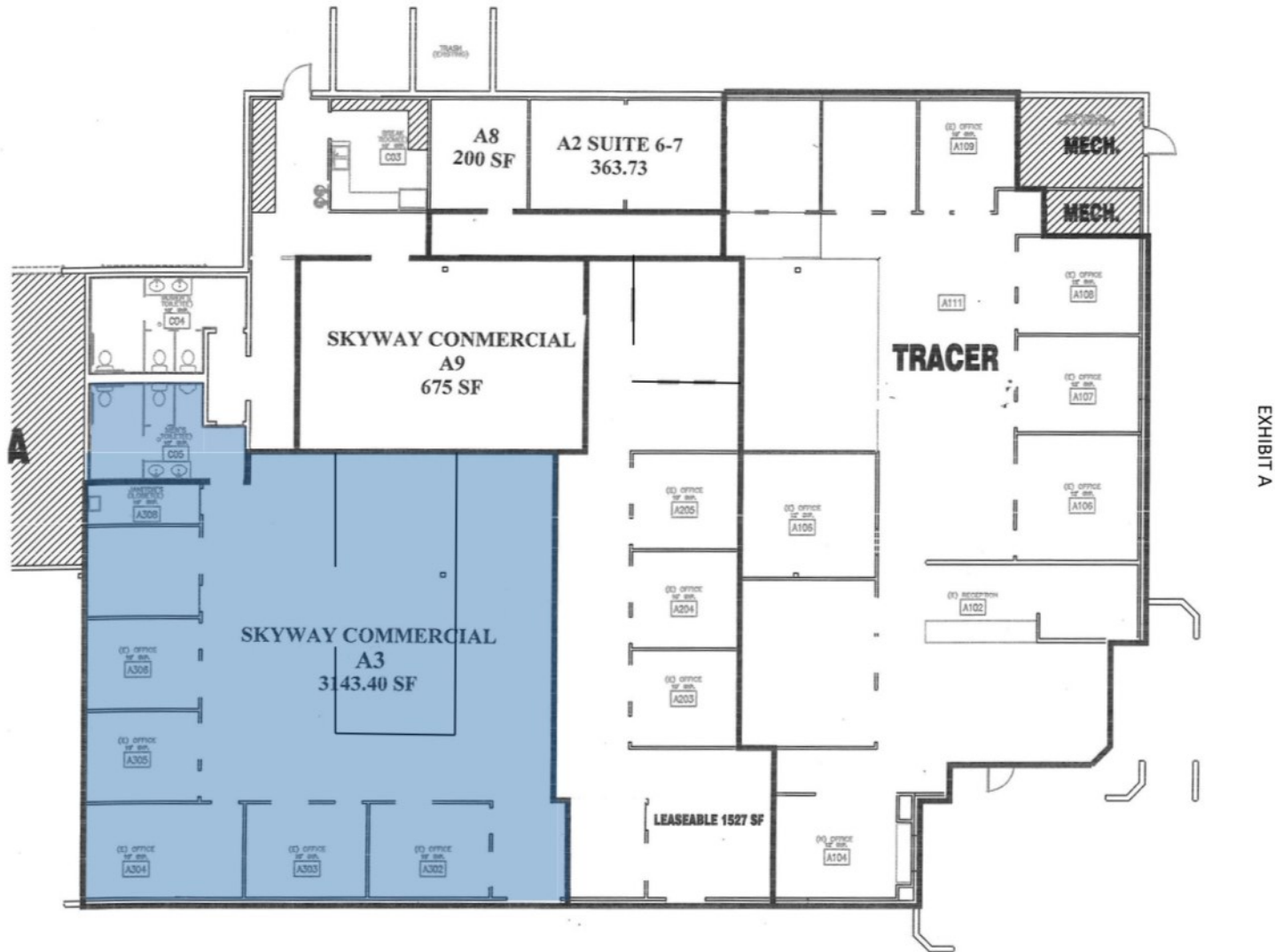

AREA MAP

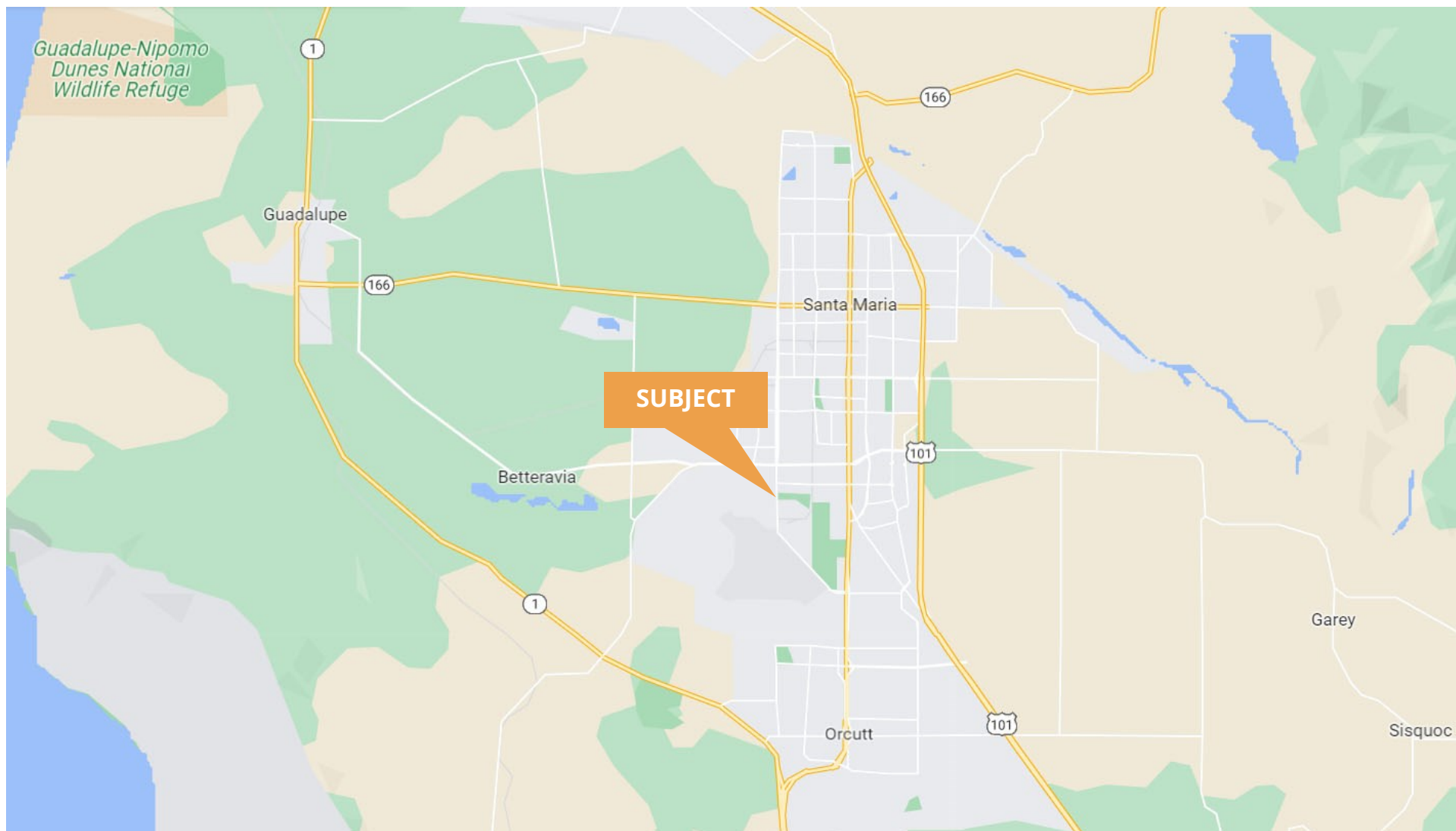

Office 805.481.9010
170 West Grand Ave, Suite 203
Grover Beach, CA 93433

Taylor Castanon
Associate DRE 02113056
Mobile 805.440.7748
Email taylor@hartcre.com